

Fan types

JK-30MTD – JK-40MTD – JK-50MTD

Page: 1/4
Revised: 15.06.2020

The direct drive centrifugal fan types JK-30MTD, JK-40MTD and JK-50MTD are designed for transport of clean air.

Equipped with backward-inclined blades and aerodynamic intake.

The impellers are statically and dynamically balanced according to ISO 10816-3.

Normally, a frequency inverter is used to control the RPM and the air volume of the fan.

Max. operating temperature: 60°C

The inlet (D) is supplied with flange as standard.

Specific dimensions for the outlet and inlet flanges can be found under “Flanges”.

Available in anti-spark version with stainless steel inlet and explosion proof (Ex) motor.

The technical data for each type appears on the following pages.

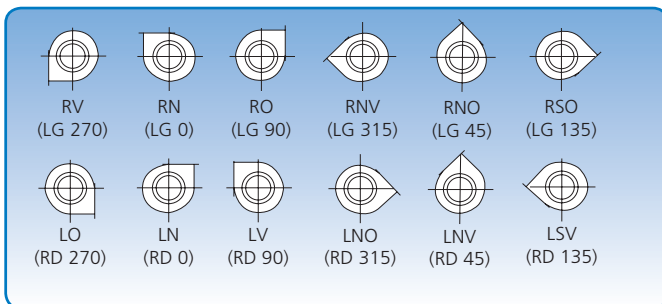
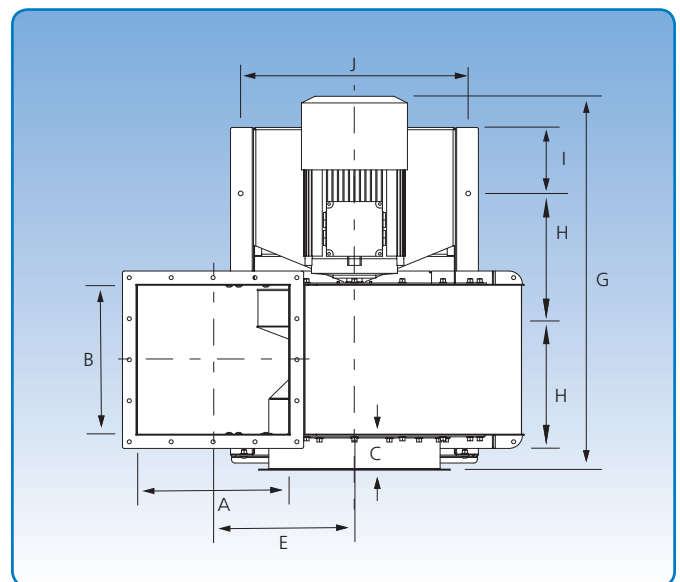
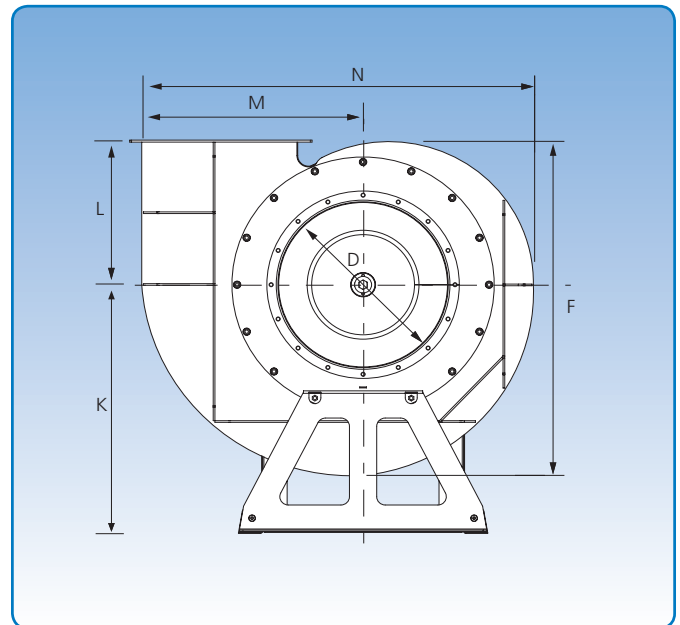

6 positions. The position illustrations are viewed from the inlet side.

Dimensions

Type	A mm	B mm	C mm	D mm	E mm	F mm	G mm	H mm	I mm	J mm	K mm	L mm	M mm	N mm	Weight without motor kg
JK-30MTD	250	250	106	300	318	645	733	275	51	430	550	276	450	768	37
JK-40MTD	350	350	106	400	368	779	903	370	49	550	650	326	550	1098	119
JK-50MTD	450	450	106	500	416	1012	1128	370	199	672	750	436	643	1146	206

Fan type JK-30MTD

Technical data

Motor: IP 55

Supplied with the following motors:

50 Hz	60 Hz	amp.	Weight of motor kg
5.5 kW	4.8 kW	7,8	45
2880 min ⁻¹	3456 min ⁻¹		

Max. RPM:

Impeller: 3,575 min⁻¹

Operating range:

Air volume: 2,000 – 6,000 m³/h

Pressure: 1,200 – 3,300 Pa

Power supply:

230/400 V

Construction:

B3 – motor mounted on foot.

Variants:

Fan can be powered by flange motor –

Type B5/B14

Impeller:

No. of blades, standard: 6 pcs.

Diameter: \varnothing 424 mm

Height: 171 mm

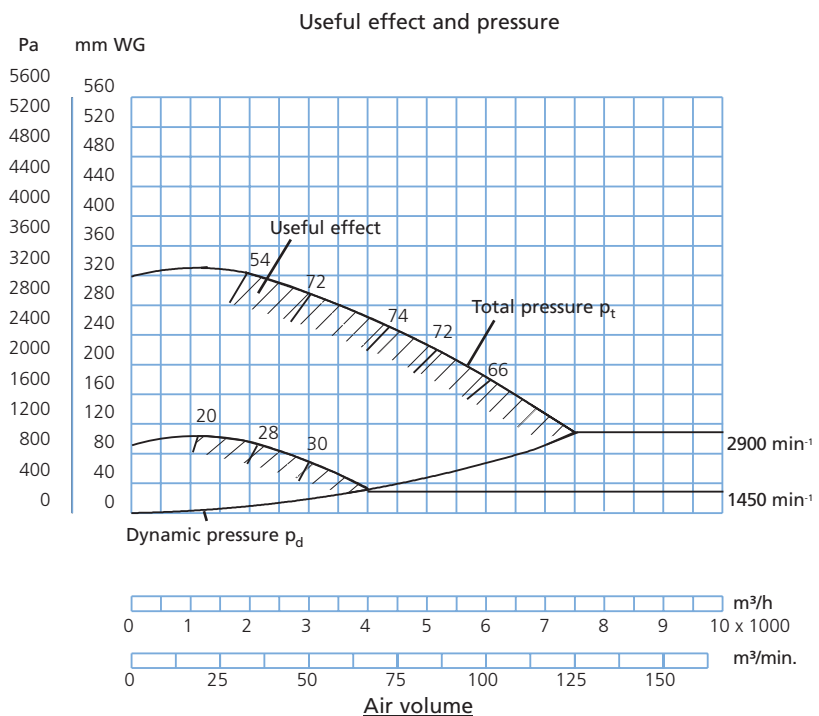
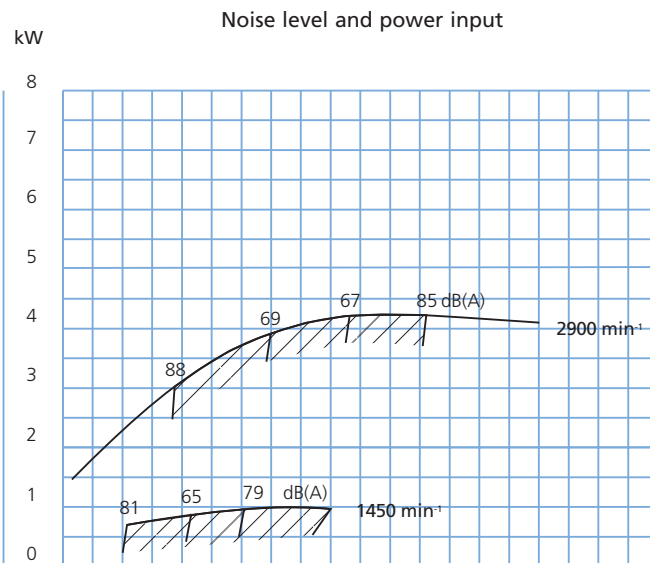

Fan type JK-40MTD

Technical data

Page: 3/4
Revised: 15.06.2020

Motor: IP 55

Supplied with the following motors:

50 Hz	60 Hz	amp.	Weight of motor kg
11 kW	13,2 kW	20,2	102
2940 min ⁻¹	3528 min ⁻¹		

Max. RPM:

Impeller: 3,575 min⁻¹

Operating range:

Air volume: 2,500 – 14,000 m³/h

Pressure: 1,200 – 4,600 Pa

Power supply:

400/690 V

Construction:

B3 – motor mounted on foot.

Impeller:

No. of blades, standard: 6 pcs.

Diameter: ø515 mm

Height: 196 mm

Noise level and power input

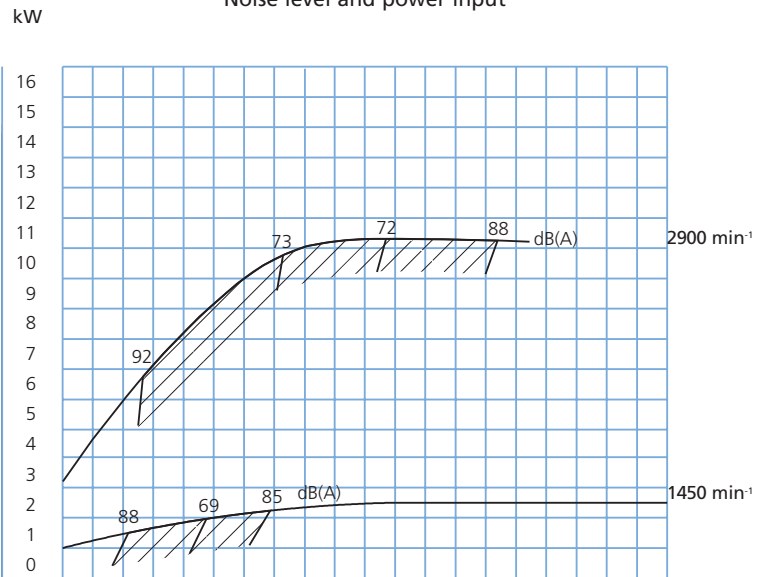

Useful effect and pressure

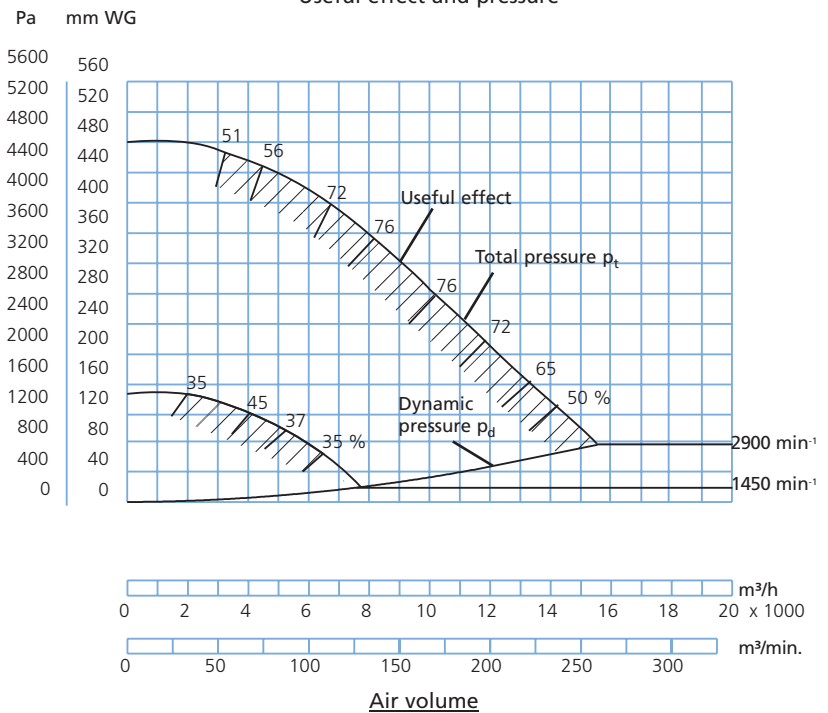

Fan type JK-50MTD

Technical data

Page: 4/4
Revised: 15.06.2020

Motor: IP 55

Supplied with the following motors:

50 Hz	60 Hz	amp.	Weight of motor kg
18,5 kW	22,2 kW	33,0	136
22,0 kW	26,4 kW	39,2	158
2940 min ⁻¹	3528 min ⁻¹		

Max. RPM:

Impeller: 3,575 min⁻¹

Operating range:

Air volume: 2,500 – 22,000 m³/h

Pressure: 1,600 – 5,900 Pa

Power supply:

400/690 V

Construction:

B3 – motor mounted on foot.

Impeller:

No. of blades, standard: 8 pcs.

Diameter: ø574/608 mm

Height: 227/224 mm

